

11/25/2025 10:38:06 AM

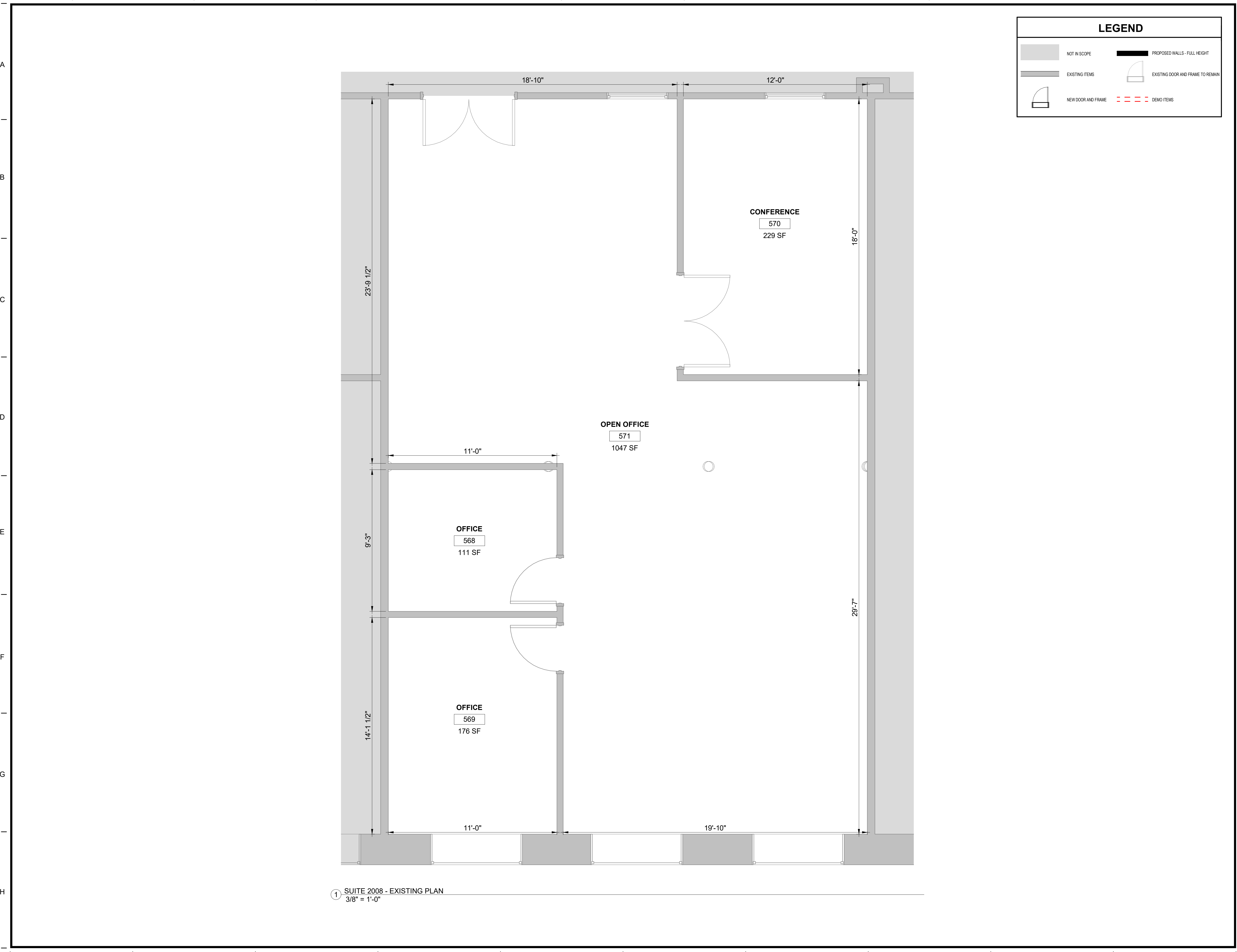

LEGEND

	NOT IN SCOPE		PROPOSED WALLS - FULL HEIGHT
	EXISTING ITEMS		EXISTING DOOR AND FRAME TO REMAIN
	NEW DOOR AND FRAME		DEMO ITEMS



Brady Sullivan Properties
 670 N. Commercial Street
 Manchester, nh 03101
 603.622.6223



Owner
BRADY SULLIVAN PROPERTIES

Project
WAUMBEC MILL

250 Commercial St.
 Manchester, NH 03101

Seals

Issues

Date	Description

Revisions

No.	Date	Description

Drawing Title
EXISTING PLAN

Issue Date:	11-25-2025
Project No:	Project Number
Scale:	As Indicated
Project Manager:	Production Leader:
Project Architect:	Peer Reviewer:

Drawing Number
AA102

① SUITE 2008 - EXISTING PLAN
 3/8" = 1'-0"