



Brady Sullivan Properties  
670 N. Commercial Street  
Manchester, nh 03101  
603.622.6223



Owner  
Owner

Project  
NEW COMMERCIAL BUILDING  
0 ISLAND STREET, KEENE NH

Suite 1 - LEASED  
Suite 2 - 2,914 SF

Seals  
Project Status

Issues	
Date	Description

Revisions		
No.	Date	Description

Drawing Title  
**PROPOSED SUITE LAYOUT**

Issue Date: 3-31-2021

Project No: Project Number Scale: 1/4" = 1'-0"

Project Manager: Production Leader:

Project Architect: Peer Reviewer:

Drawing Number

**B1-1**

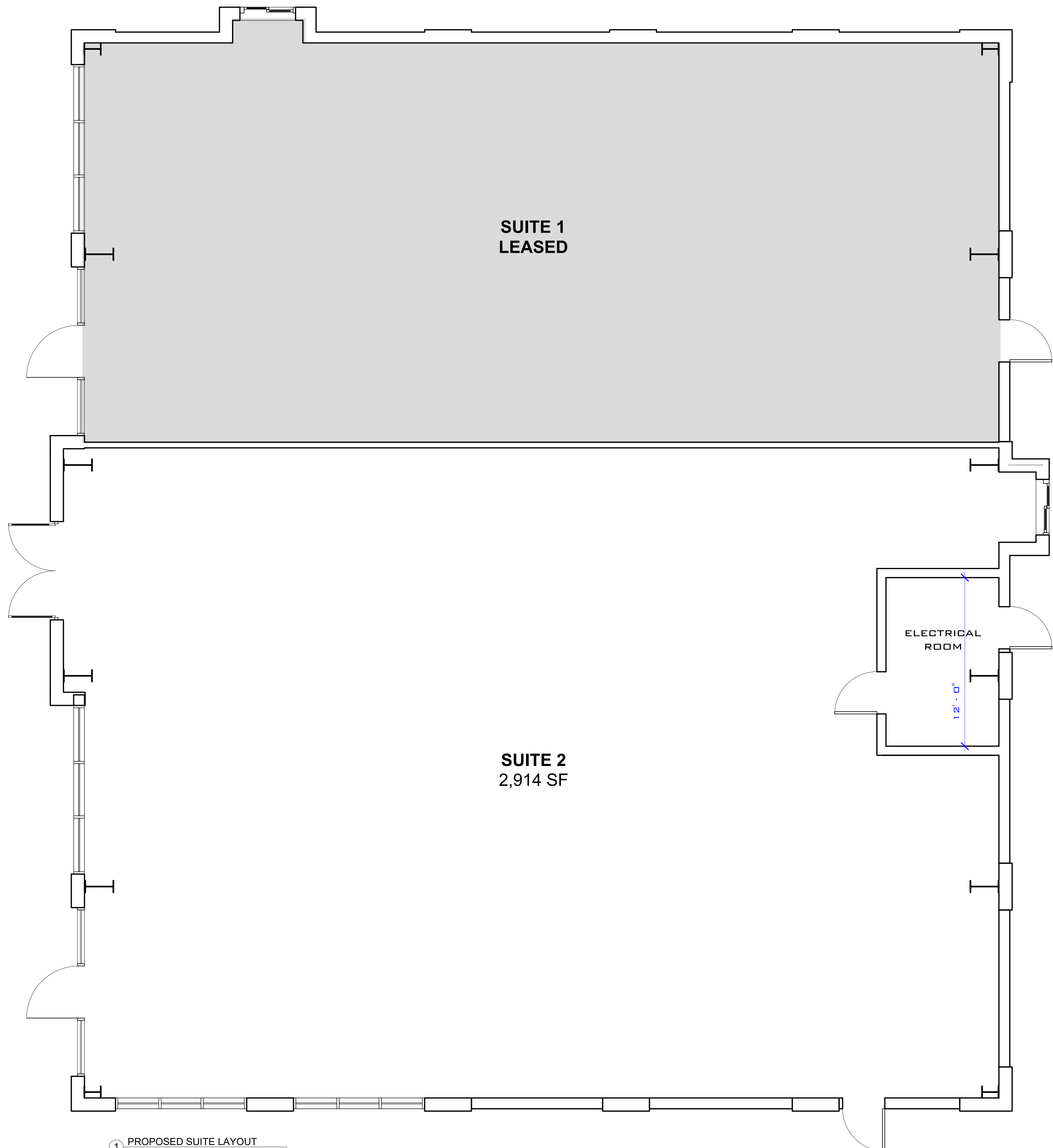

1 PROPOSED SUITE LAYOUT  
1/4" = 1'-0"

**DISCLAIMER:** ALL BUILDOUT IS BASED ON BRADY SULLIVAN PROPERTIES "CONSTRUCTION STANDARDS".  
BRADY SULLIVAN PROPERTIES RESERVES THE RIGHT TO ISSUE A CHANGE ORDER FOR ADDITIONAL WORK  
NOT INCLUDED IN DRAWINGS.

3/31/2021 12:40:04 PM