



Brady Sullivan Properties
670 N. Commercial Street
Manchester, nh 03101
603.622.6223

PROPERTY OF THE UNITED STATES GOVERNMENT
COPYING, DISSEMINATION, OR DISTRIBUTION OF
THESE DRAWINGS, PLANS, OR SPECIFICATIONS TO
UNAUTHORIZED PERSONS IS PROHIBITED
Do not remove this notice. Properly destroy documents
when no longer
needed.

© 2015 Brady Sullivan Properties

Owner

Project

BUILDING 35 E

ROCHESTER NH

CALLLED NORTH

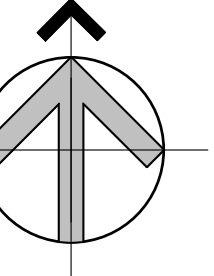

Seals

Issues

Date	Description

Revisions

No.	Date	Description

Drawing Title

GROUND FLOOR

Issue Date:

Project No: Scale: 1/8" = 1'-0"

Project Manager: Production Leader:

Project Architect: CL Peer Reviewer: CL

Drawing Number

A1.0

11/11/2015 2:34:33 PM

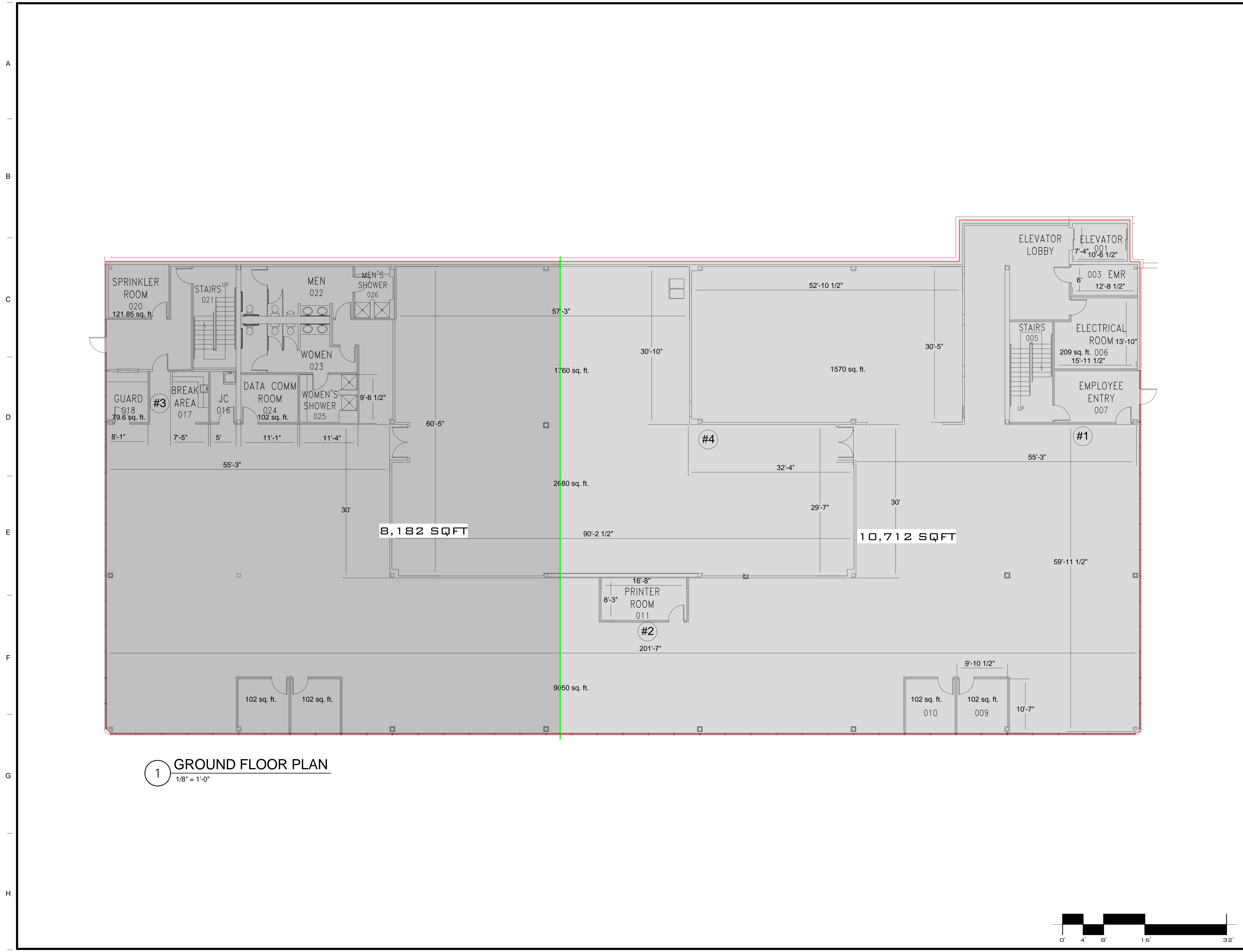

1 GROUND FLOOR PLAN
1/8" = 1'-0"

