





LEGEND			
	NOT IN SCOPE		PROPOSED ITEMS (HEAVY LINE WEIGHT)
	EXISTING ITEMS		DEMO ITEMS
	NEW DOOR AND FRAME		EXISTING DOOR AND FRAME TO REMAIN



Brady Sullivan Properties  
 670 N. Commercial Street  
 Manchester, nh 03101  
 603.622.6223

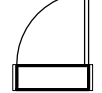

Owner  
**BRADY SULLIVAN  
 PROPERTIES**  
 MANCHESTER,  
 NH

Project  
**22 COTTON ROAD**

NASHUA, NH

Seals

Issues	
Date	Description

Revisions	
No.	Date

Drawing Title  
**VACANT  
 RENOVATION  
 10,701 RSF**

Issue Date:	2-20-2019
Project No:	Scale: As indicated
Project Manager:	Production Leader:
Project Architect: RO	Peer Reviewer: RO

Drawing Number  
**A1-4**

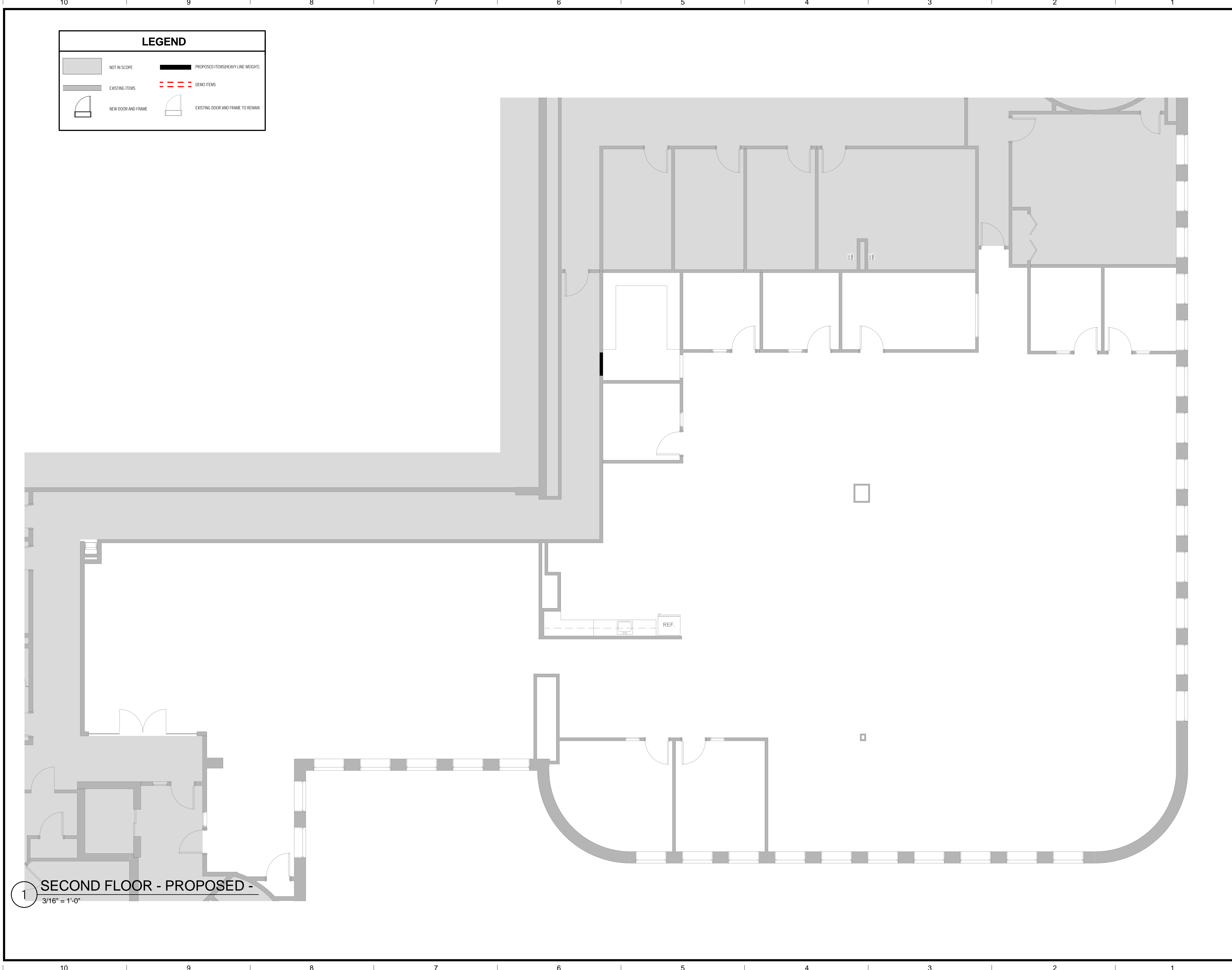

2/20/2019 9:10:28 AM