

7/15/2020 1:08:50 PM

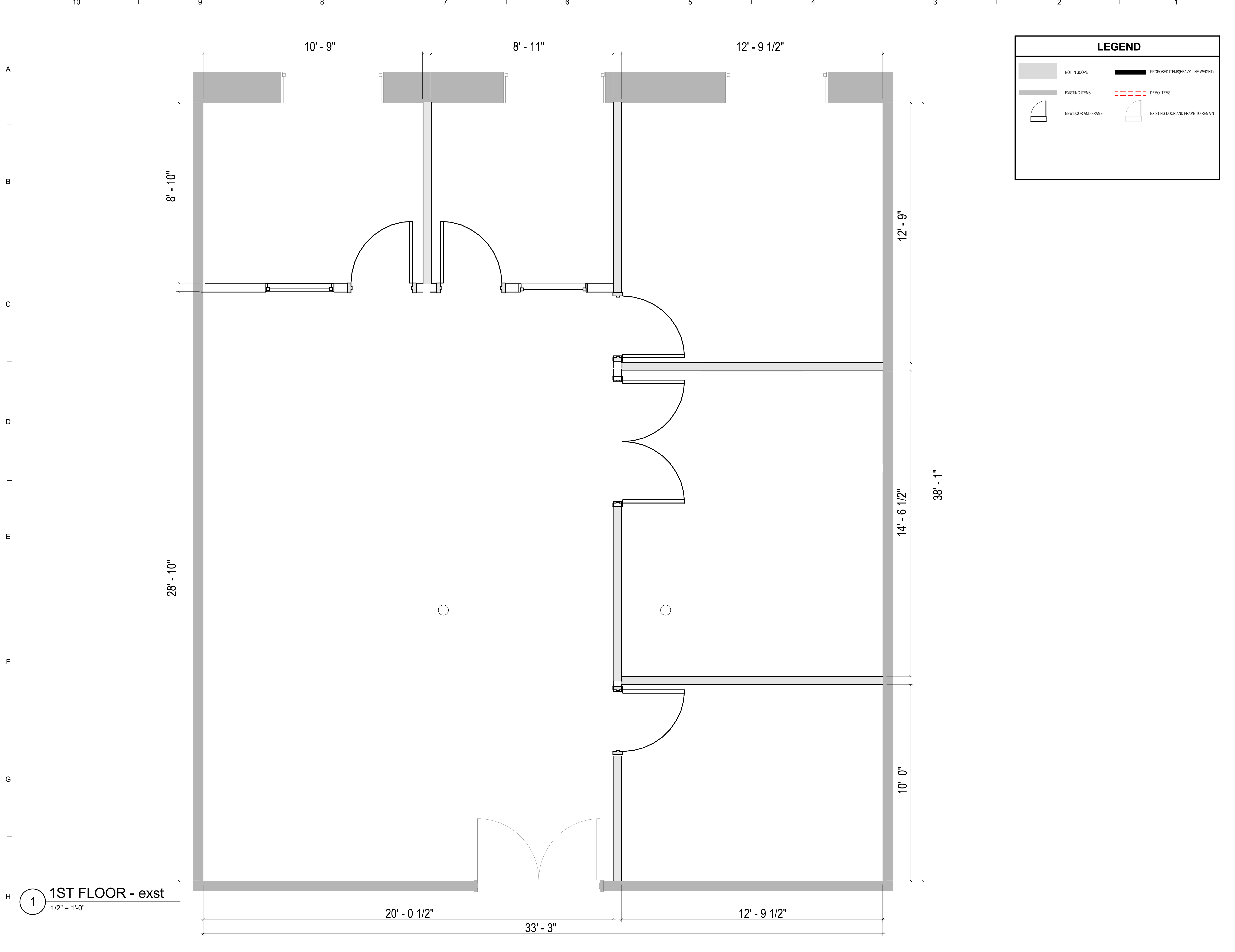

**LEGEND**

	NOT IN SCOPE		PROPOSED ITEMS (HEAVY LINE WEIGHT)
	EXISTING ITEMS		DEMO ITEMS
	NEW DOOR AND FRAME		EXISTING DOOR AND FRAME TO REMAIN



Brady Sullivan Properties  
 670 N. Commercial Street  
 Manchester, nh 03101  
 603.622.6223



Owner  
**BRADY SULLIVAN  
 PROPERTIES**  
 MANCHESTER NH

Project  
**WAUMBEC MILL**  
 MANCHESTER NH

Seals  
 PROGRESS PRINT

1,553 RSF

Issues	
Date	Description

Revisions	
No.	Description

Drawing Title  
**SUITE 4021**

Issue Date:	7-15-2020
Project No:	Scale: As indicated
Project Manager:	Production Leader:
Project Architect:	Peer Reviewer:

Drawing Number  
**A.106**