

7/15/2020 1:08:50 PM

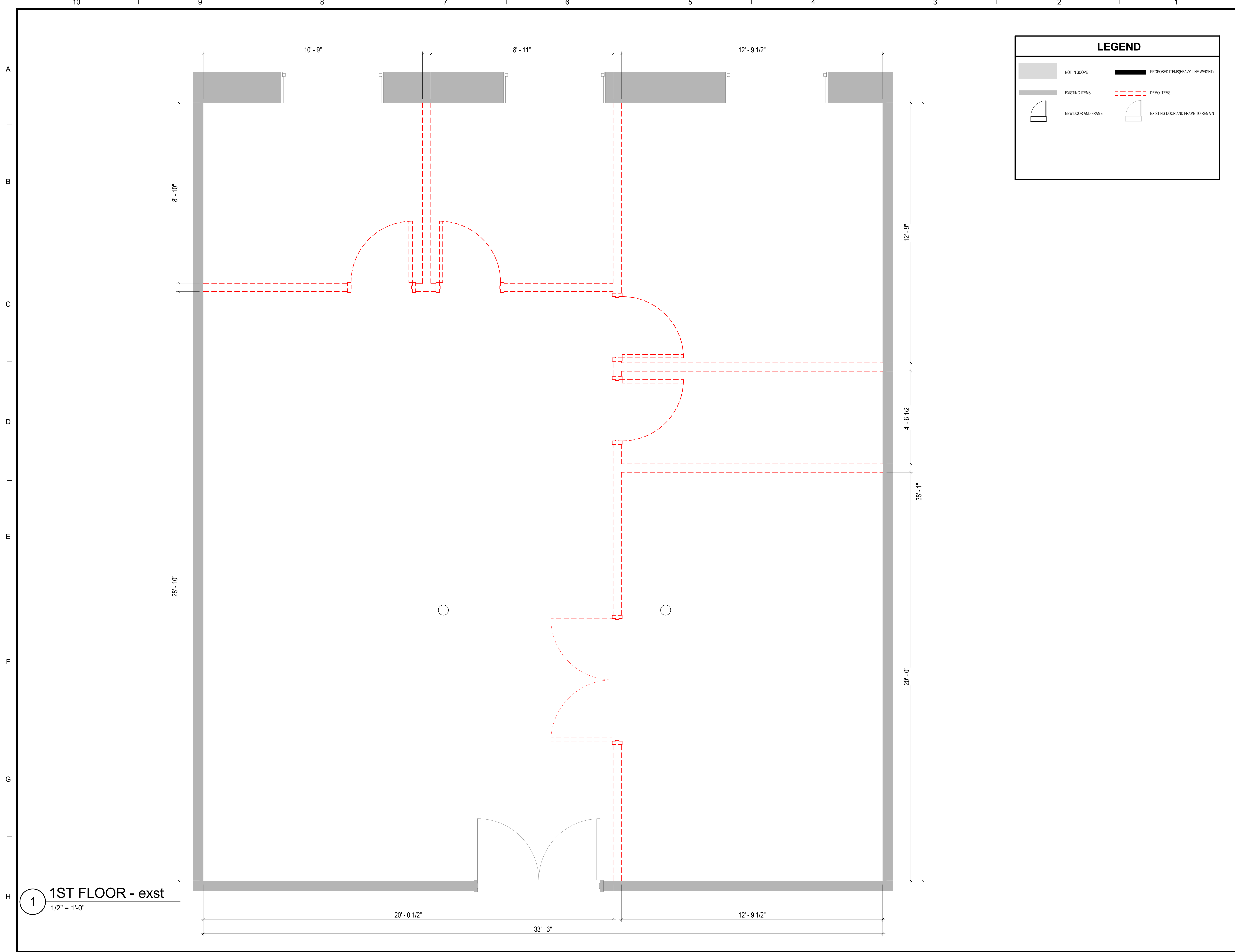

LEGEND

- NOT IN SCOPE
- EXISTING ITEMS
- NEW DOOR AND FRAME
- PROPOSED ITEMS (HEAVY LINE WEIGHT)
- DEMO ITEMS
- EXISTING DOOR AND FRAME TO REMAIN



Brady Sullivan Properties
 670 N. Commercial Street
 Manchester, nh 03101
 603.622.6223



Owner
BRADY SULLIVAN
 PROPERTIES
 MANCHESTER NH

Project
WAUMBEC MILL
 MANCHESTER NH

Seals
 PROGRESS PRINT

1,553 RSF

Issues

Date	Description

Revisions

No.	Date	Description

Drawing Title
SUITE 4021

Issue Date:	7-15-2020
Project No:	Scale: As indicated
Project Manager:	Production Leader:
Project Architect:	Peer Reviewer:

Drawing Number
A.106