

3/9/2020 9:03:23 AM

10 9 8 7 6 5 4 3 2 1

A B C D E F G H

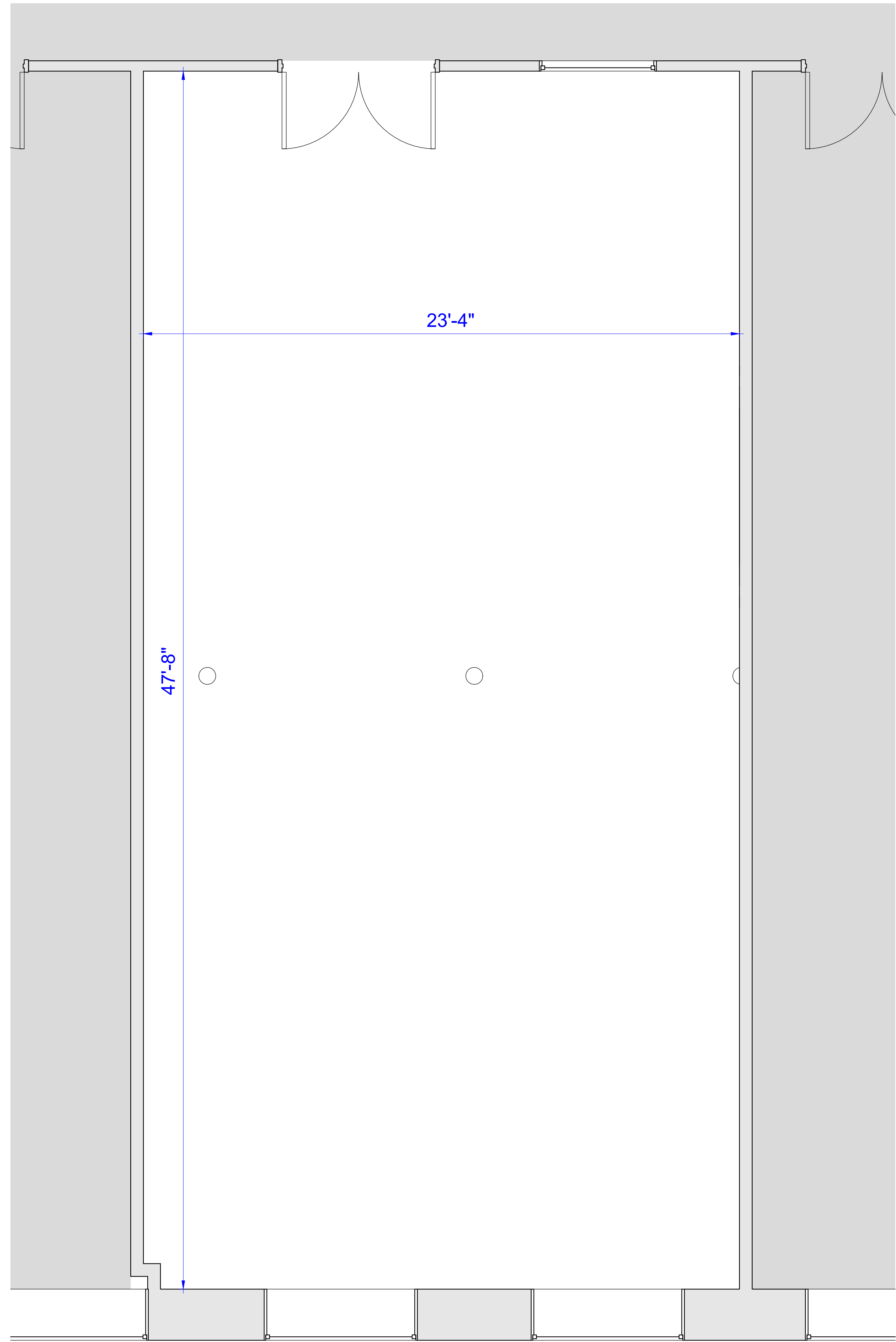

LEGEND

[Light Gray Box]	NOT IN SCOPE	[Thick Black Line]	PROPOSED WALLS - FULL HEIGHT
[Medium Gray Box]	EXISTING ITEMS	[Thin Black Line]	PROPOSED WALL - 8' HIGH
[Dashed Red Line]	DEMO ITEMS	[Door Symbol]	NEW DOOR AND FRAME
[Door Symbol]	EXISTING DOOR AND FRAME TO REMAIN		



Brady Sullivan Properties
 670 N. Commercial Street
 Manchester, nh 03101
 603.622.6223



Owner
**BRADY SULLIVAN
 PROPERTIES**

Project
WAUMBEC MILL
 250 Commercial St, Manchester, NH
 03101

**SUITE 2003B
 1,280 SF**

Seals
 0%

Issues

Date	Description

Revisions

No.	Date	Description

Drawing Title

Issue Date:	3-9-2020
Project No:	Project Number
Scale:	As indicated
Project Manager:	Production Leader:
Project Architect:	Peer Reviewer:

Drawing Number
E1.34

10 9 8 7 6 5 4 3 2 1