

3/9/2020 9:03:23 AM

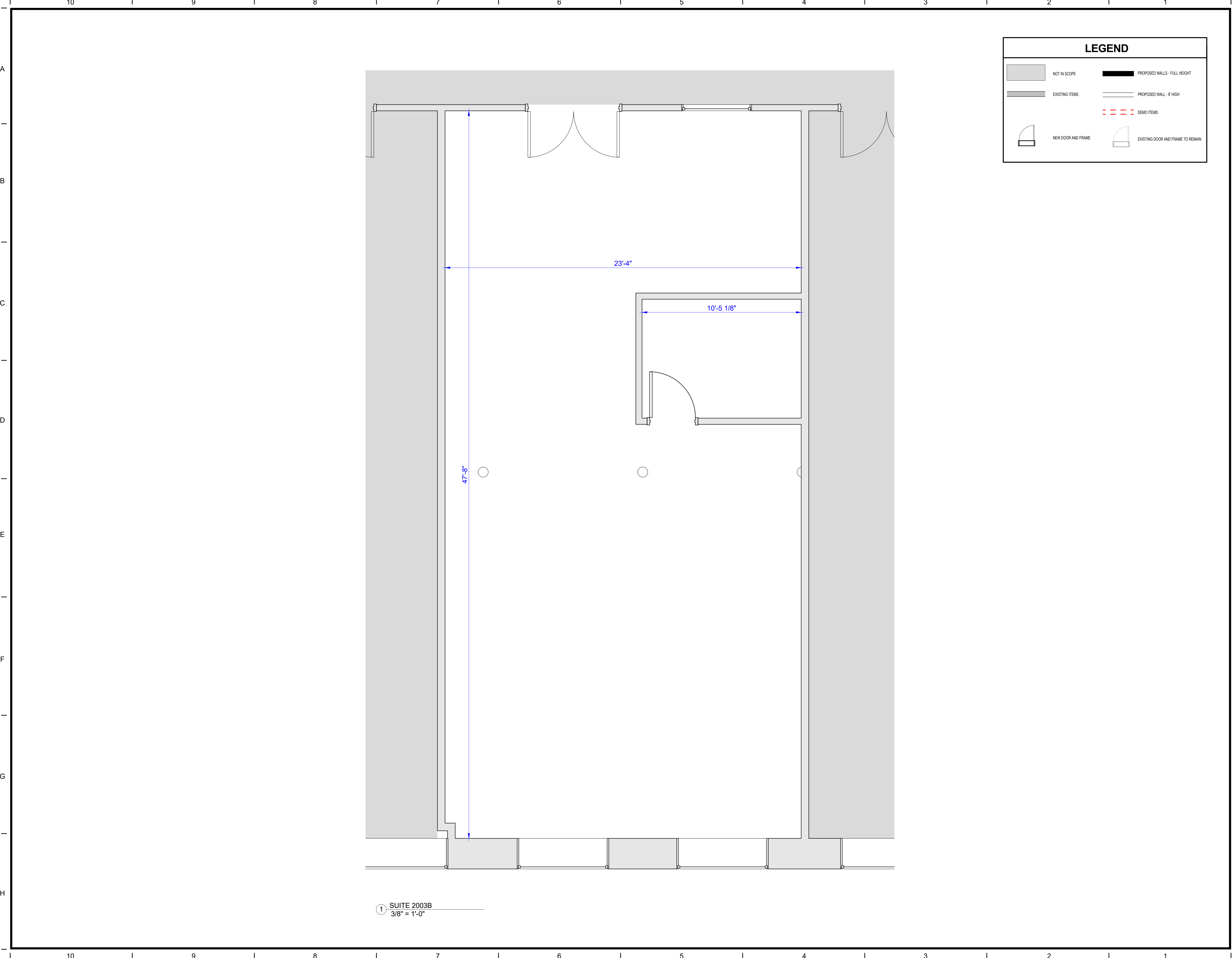

**LEGEND**

[Light Gray Box]	NOT IN SCOPE	[Thick Black Line]	PROPOSED WALLS - FULL HEIGHT
[Medium Gray Box]	EXISTING ITEMS	[Thin Black Line]	PROPOSED WALL - 8' HIGH
[Dashed Red Line]		[Dashed Red Line]	DEMO ITEMS
[Door Symbol]	NEW DOOR AND FRAME	[Door Symbol]	EXISTING DOOR AND FRAME TO REMAIN



Brady Sullivan Properties  
 670 N. Commercial Street  
 Manchester, nh 03101  
 603.622.6223



Owner  
**BRADY SULLIVAN PROPERTIES**

Project  
**WAUMBEC MILL**  
 250 Commercial St, Manchester, NH  
 03101

Seals  
 0%

Issues

Date	Description

Revisions

No.	Date	Description

Drawing Title  
**SUITE 2003B**

Issue Date:	3-9-2020		
Project No:	Project Number	Scale:	As indicated
Project Manager:	Production Leader:		
Project Architect:	Peer Reviewer:		

Drawing Number  
**E1.34**

① SUITE 2003B  
 3/8" = 1'-0"