



Brady Sullivan Properties
670 N. Commercial Street
Manchester, nh 03101
603.622.6223



Owner
**BRADY SULLIVAN
PROPERTIES**
MANCHESTER
NH

Project
1750 ELM STREET
MANCHESTER NH

Seals
PROGRESS PRINT

Issues	
Date	Description

Revisions		
No.	Date	Description

Drawing Title
SUITE 406
812 RSF

Issue Date: 4-24-2017
Project No: Scale: 1/2" = 1'-0"
Project Manager: Production Leader:
Project Architect: Peer Reviewer:

Drawing Number
A.107

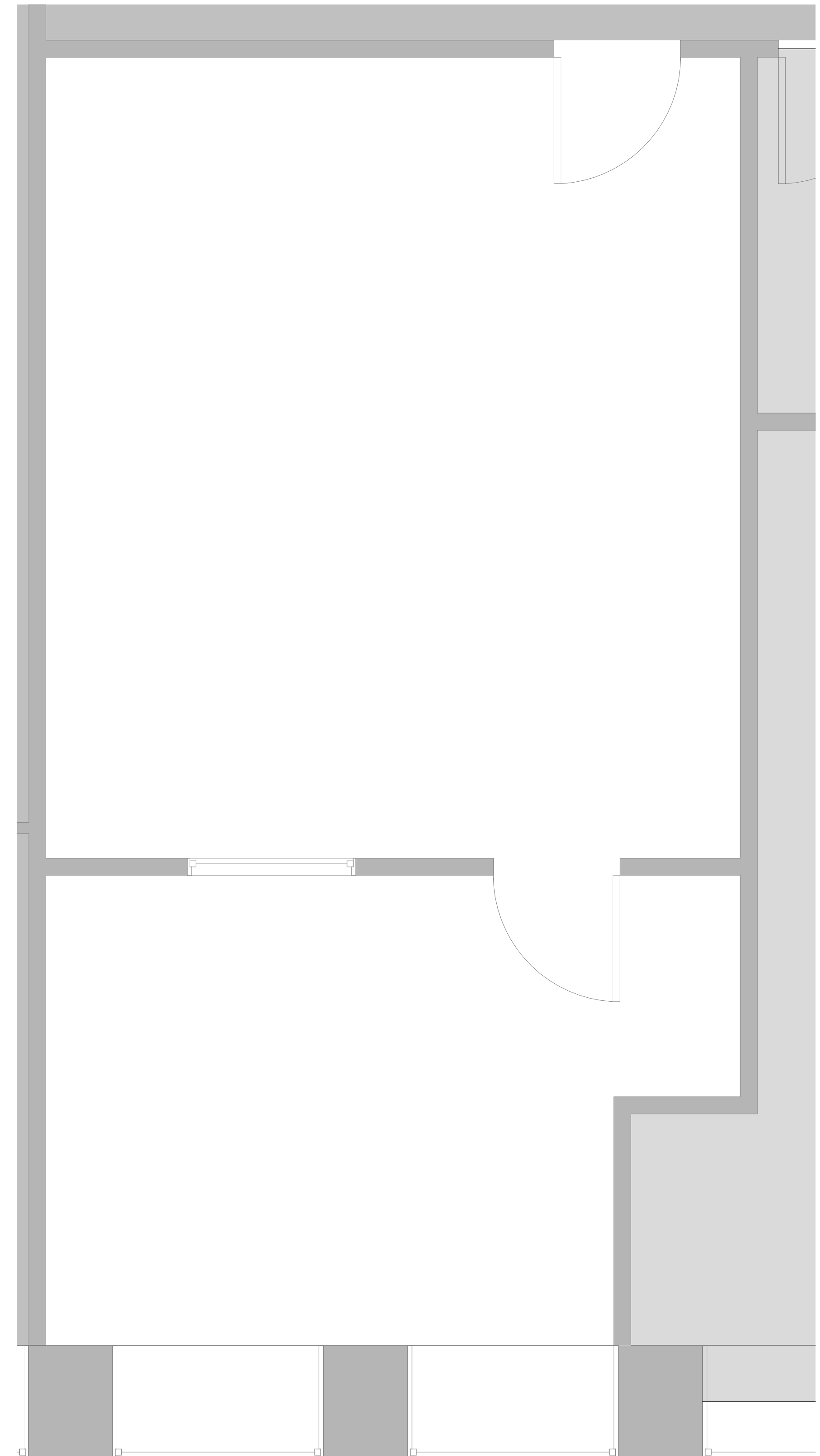

1 4TH FLOOR - EXHIBIT
1/2" = 1'-0"

DISCLAIMER: ALL BUILDOUT IS BASED ON BRADY SULLIVAN PROPERTIES "CONSTRUCTION STANDARDS".
BRADY SULLIVAN PROPERTIES RESERVES THE RIGHT TO ISSUE A CHANGE ORDER FOR ADDITIONAL WORK
NOT INCLUDED IN DRAWINGS.

4/24/2017 4:12:27 PM