



Brady Sullivan Properties
670 N. Commercial Street
Manchester, nh 03101
603.622.6223



Owner
BRADY SULLIVAN PROPERTIES
8 COMMERCE DRIVE
BEDFORD NH

Project

THIRD FLOOR

Seals

Issues	
Date	Description

Revisions		
No.	Date	Description

Drawing Title

Issue Date: 10-24-2019

Project No: Scale: 3/32" = 1'-0"

Project Manager: Production Leader:

Project Architect: CL Peer Reviewer: CL

Drawing Number

A0.5

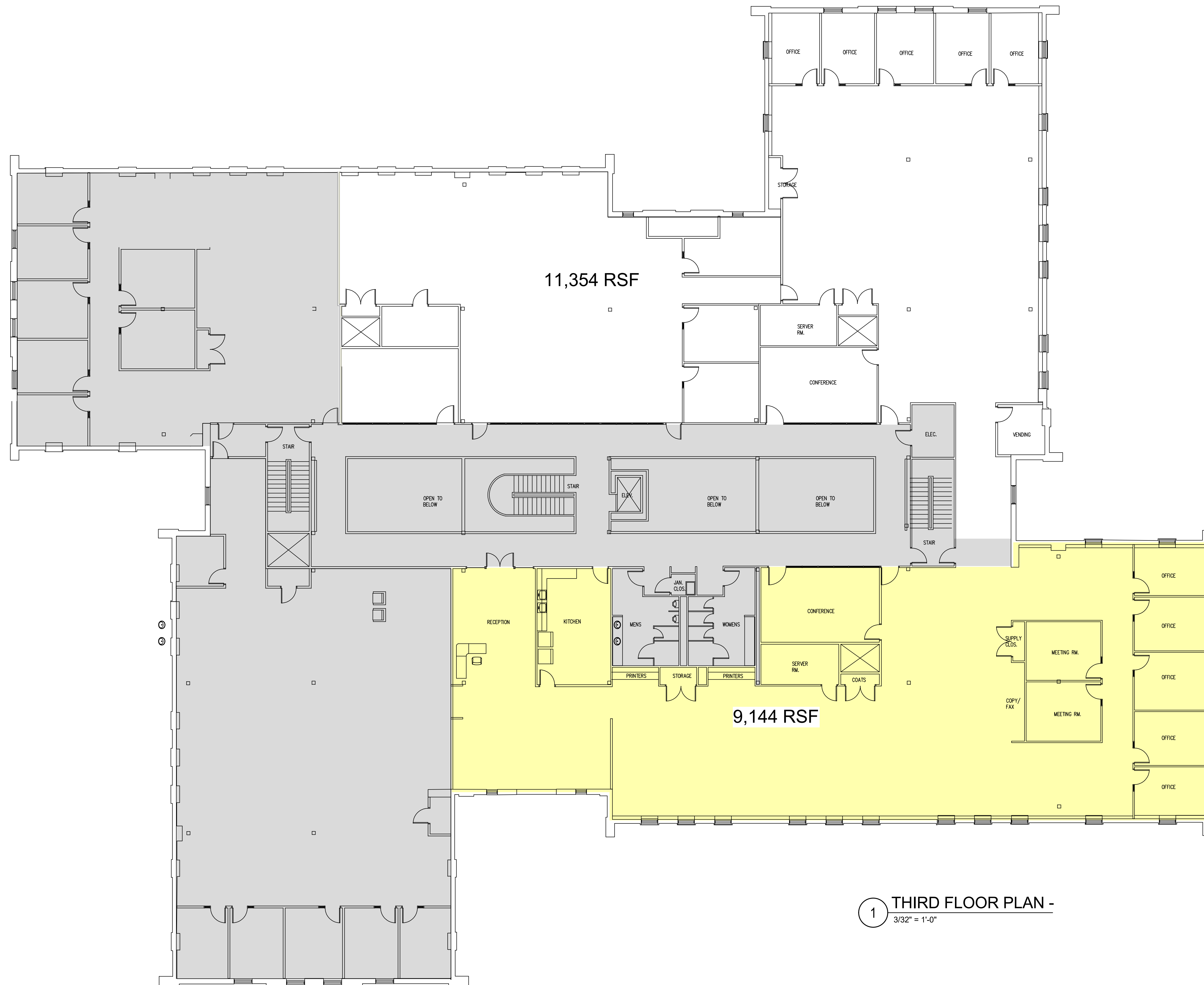

11,354 RSF

9,144 RSF

1 THIRD FLOOR PLAN -
3/32" = 1'-0"

DISCLAIMER: ALL BUILDOUT IS BASED ON BRADY SULLIVAN PROPERTIES "CONSTRUCTION STANDARDS". BRADY SULLIVAN PROPERTIES RESERVES THE RIGHT TO ISSUE A CHANGE ORDER FOR ADDITIONAL WORK NOT INCLUDED IN DRAWINGS.

11/7/2019 11:06:45 AM