

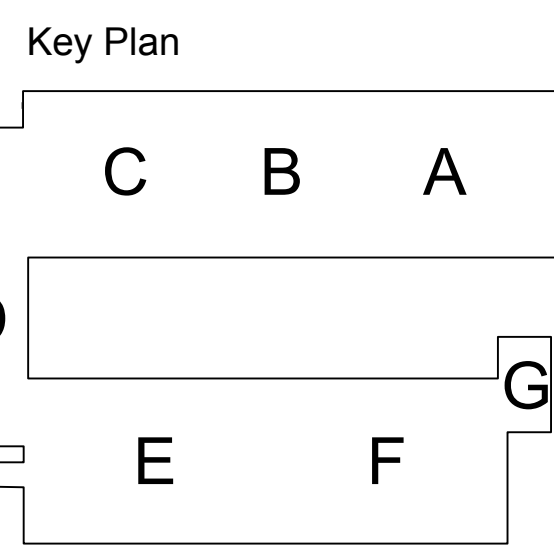

GENERAL FLOOR PLAN NOTES

1. ALL EXISTING NON-STRUCTURAL WALLS, PLUMBING, ELECTRICAL, AND MECHANICAL EQUIPMENT (EXCEPT FOR 2 STOR OFFICE BUILDING) TO BE REMOVED AND 91 RESIDENTIAL UNITS, 33 PARKING SPACES, COMMON AREAS, AND MANAGEMENT OFFICE TO BE CONSTRUCTED.
2. ALL EXISTING WINDOWS AND WINDOW INFILLS TO BE REMOVED AND REPLACED WITH NEW ALUMINUM WINDOW ASSEMBLY, EXCEPT AS NOTED ON WINDOW REPLACEMENT SCHEDULE. SEE HISTORIC WINDOW SURVEY FOR REPLACEMENT SCHEDULE.
3. ALL EXISTING, ORIGINAL, INTERIOR PASSAGE DOORS ARE TO BE RETAINED AND NEEDED.
4. EXISTING WOOD FLOORING TO REMAIN IN PROPOSED COMMON AREAS.

KEY TO FLOOR PLAN NOTES

1. EXISTING STAIRS, HANDRAILS, INTERIOR FINISHES, AND EGRESS DOORS ARE TO BE RETAINED AND AS NEEDED. NEW RATED WALLS TO BE CONSTRUCTED AROUND OUTSIDE OF EXISTING SHAFT. THE STAIR IS TO REMAIN IN ACTIVE USE. SEE SHEET A6.01 FOR STAIR REHAB PLAN.
2. EXISTING STAIRS, HANDRAILS, AND INTERIOR FINISHES ARE TO BE RETAINED AND REPAIRED AS NEEDED. NEW RATED WALLS TO BE CONSTRUCTED AROUND OUTSIDE OF EXISTING SHAFT. EXISTING EGRESS DOORS ARE TO BE RETAINED, REPAIRED AS NEEDED, AND FIXED CLOSED. NEW OPENINGS TO BE CUT IN WEST SIDE OF EXISTING LANDING AND A RATED VESTIBULE TO BE CONSTRUCTED OUTSIDE OF THE STAIRWELL. THE STAIR IS TO REMAIN IN ACTIVE USE. SEE SHEET A6.01 FOR REHAB PLAN.
3. EXISTING STAIRS, HANDRAILS, AND INTERIOR FINISHES ARE TO BE RETAINED AND REPAIRED AS NEEDED. NEW RATED WALLS TO BE CONSTRUCTED AROUND OUTSIDE OF EXISTING SHAFT. EXISTING EGRESS DOORS ARE TO BE RETAINED, REPAIRED AS NEEDED, AND FIXED CLOSED. THE STAIR WILL ONLY BE ACCESSIBLE SEE SHEET A6.01 FOR REHAB PLAN.
4. COLUMN TO BE REMOVED TO ALLOW VEHICULAR ACCESS IN PROPOSED PARKING GARAGE. NEW BEAMS TO BE SISTERED TO EXISTING TO PROVIDE STRUCTURAL STABILITY.
5. NOT USED
6. EXISTING BASEMENT BASEMENT ACCESS STAIRS TO BE REMOVED AND OPENING IN FLOOR INFILLED. NEW BASEMENT ACCESS STAIRS TO BE CONSTRUCTED IN ADJACENT LOCATION.
7. EXISTING ELEVATOR AND SHAFT TO REMAIN, REPAIRED AS REQUIRED
8. NEW ELEVATOR SHAFT TO BE CONSTRUCTED AND NEW ELEVATOR INSTALLED.





Hresko Associates, Inc.  
Architect  
Landscape Architect  
110 Broad Street  
Boston, MA 02110  
617-350-7666  
fax: 617-350-6260  
eMail: hresko@ArchUSA.com

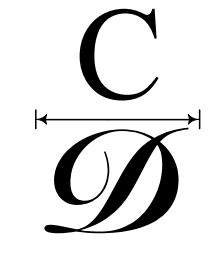

CONCISE DESIGN  
Architects  
7 Kent Street #4  
Brookline, MA 02445  
617.285.0872  
andrew@concisedes.com

# POCASSET MILL

75 Pocasset Street, Johnston, Rhode Island



Basement Plan

Date: 6 January 2012  
Scale: 1/16"= 1'-0"

#29-06

A  
1.00

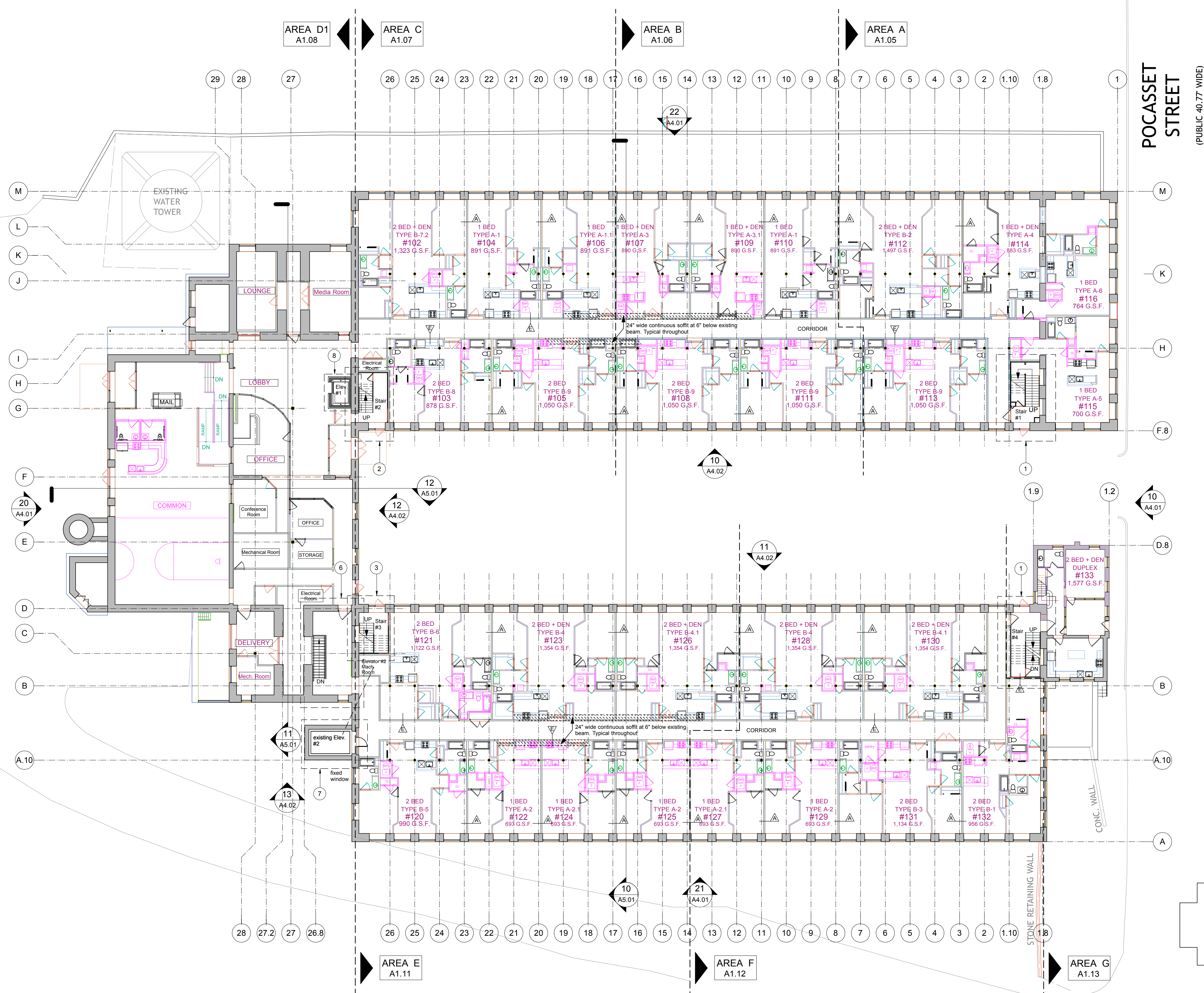

### GENERAL FLOOR PLAN NOTES

1. ALL EXISTING NON-STRUCTURAL WALLS, PLUMBING, ELECTRICAL, AND MECHANICAL EQUIPMENT (EXCEPT FOR 2 STOR OFFICE BUILDING) TO BE REMOVED AND 91 RESIDENTIAL UNITS, 33 PARKING SPACES, COMMON AREAS, AND MANAGEMENT OFFICE TO BE CONSTRUCTED.
2. ALL EXISTING WINDOWS AND WINDOW INFILLS TO BE REMOVED AND REPLACED WITH NEW ALUMINUM WINDOW ASSEMBLY, EXCEPT AS NOTED ON WINDOW REPLACEMENT SCHEDULE. SEE HISTORIC WINDOW SURVEY FOR REPLACEMENT SCHEDULE.
3. ALL EXISTING, ORIGINAL, INTERIOR PASSAGE DOORS ARE TO BE RETAINED AND NEEDED.
4. EXISTING WOOD FLOORING TO REMAIN IN PROPOSED COMMON AREAS.

### KEY TO FLOOR PLAN NOTES

1. EXISTING STAIRS, HANDRAILS, INTERIOR FINISHES, AND EGRESS DOORS ARE TO BE RETAINED AND AS NEEDED. NEW RATED WALLS TO BE CONSTRUCTED AROUND OUTSIDE OF EXISTING SHAFT. THE STAIR IS TO REMAIN IN ACTIVE USE. SEE SHEET A6.01 FOR STAIR REHAB PLAN.
2. EXISTING STAIRS, HANDRAILS, AND INTERIOR FINISHES ARE TO BE RETAINED AND REPAIRED AS NEEDED. NEW RATED WALLS TO BE CONSTRUCTED AROUND OUTSIDE OF EXISTING SHAFT. EXISTING EGRESS DOORS ARE TO BE RETAINED, REPAIRED AS NEEDED, AND FIXED CLOSED. NEW OPENINGS TO BE CUT IN WEST SIDE OF EXISTING LANDING AND A RATED VESTIBULE TO BE CONSTRUCTED OUTSIDE OF THE STAIRWELL. THE STAIR IS TO REMAIN IN ACTIVE USE. SEE SHEET A6.01 FOR REHAB PLAN.
3. EXISTING STAIRS, HANDRAILS, AND INTERIOR FINISHES ARE TO BE RETAINED AND REPAIRED AS NEEDED. NEW RATED WALLS TO BE CONSTRUCTED AROUND OUTSIDE OF EXISTING SHAFT. EXISTING EGRESS DOORS ARE TO BE RETAINED, REPAIRED AS NEEDED, AND FIXED CLOSED. THE STAIR WILL ONLY BE ACCESSIBLE SEE SHEET A6.01 FOR REHAB PLAN.
4. COLUMN TO BE REMOVED TO ALLOW VEHICULAR ACCESS IN PROPOSED PARKING GARAGE. NEW BEAMS TO BE SISTERED TO EXISTING TO PROVIDE STRUCTURAL STABILITY.
5. NOT USED
6. EXISTING BASEMENT BASEMENT ACCESS STAIRS TO BE REMOVED AND OPENING IN FLOOR INFILLED. NEW BASEMENT ACCESS STAIRS TO BE CONSTRUCTED IN ADJACENT LOCATION.
7. EXISTING ELEVATOR AND SHAFT TO REMAIN, REPAIRED AS REQUIRED
8. NEW ELEVATOR SHAFT TO BE CONSTRUCTED AND NEW ELEVATOR INSTALLED.

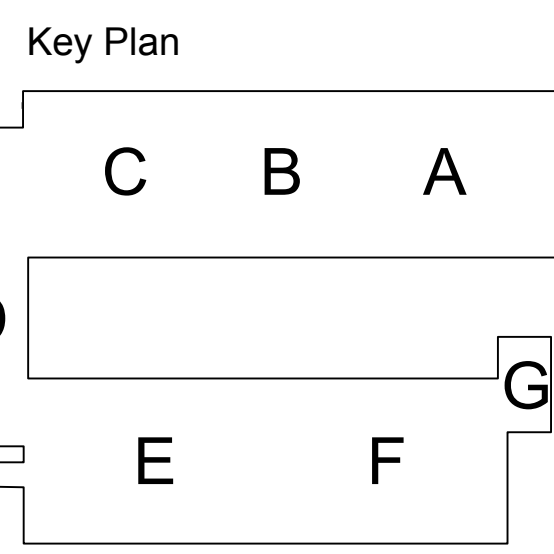

**Hresko Associates, Inc.**  
*Architect*  
**Landscape Architect**  
 110 Broad Street  
 Boston, MA 02110  
 617-350-7666  
 fax: 617-350-6260  
 eMail: hresko@ArchUSA.com

**CONCISE DESIGN**  
*Architects*  
 7 Kent Street #4  
 Brookline, MA 02445  
 617.285.0872  
 andrew@concisedes.com

# POCASSET MILL

75 Pocasset Street, Johnston, Rhode Island

**1st Floor Plan**  
 Date: 6 January 2012  
 Scale: 1/16"= 1'-0"

#29-06  
**A**  
**1.01**



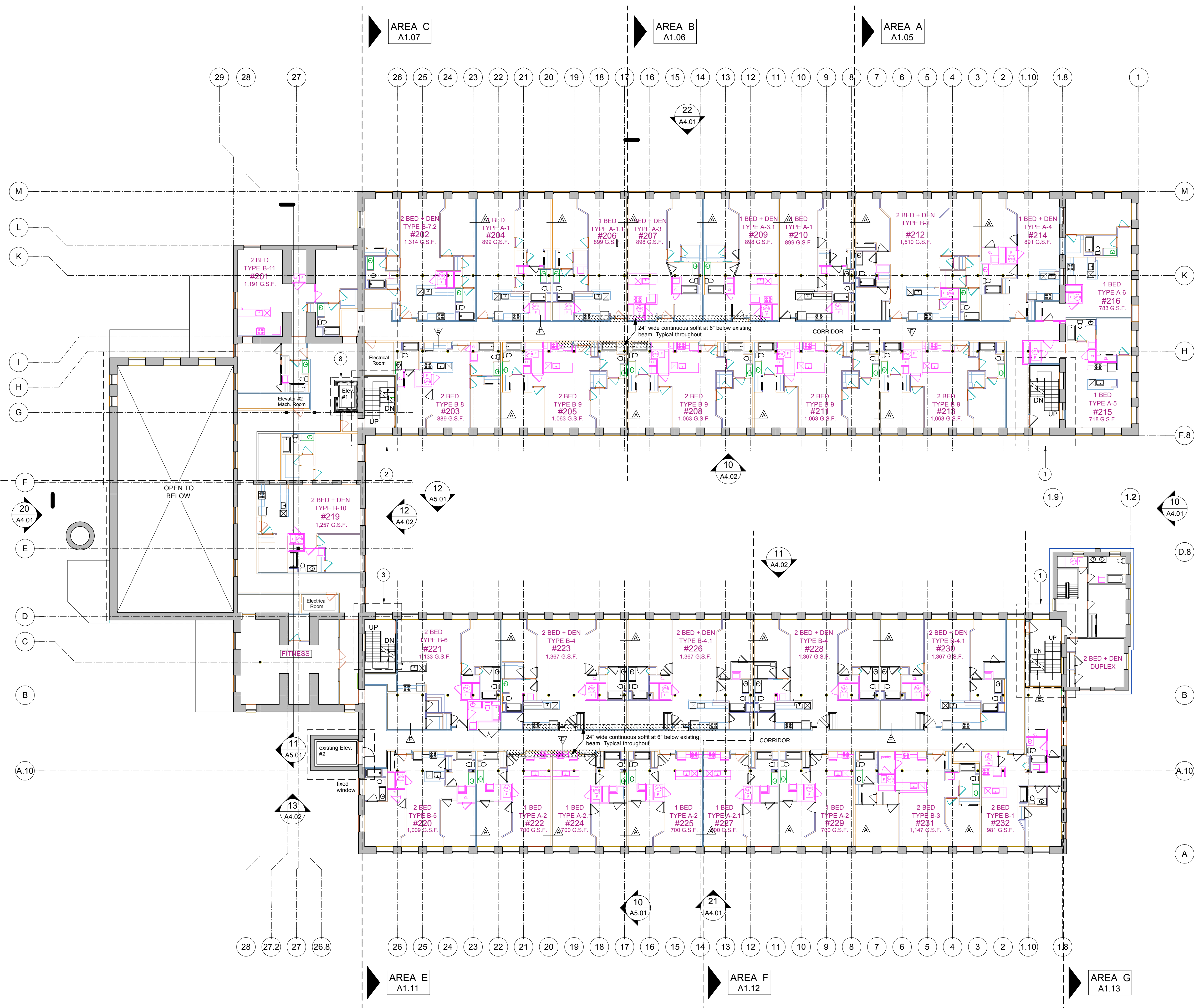

#### GENERAL FLOOR PLAN NOTES

1. ALL EXISTING NON-STRUCTURAL WALLS, PLUMBING, ELECTRICAL, AND MECHANICAL EQUIPMENT (EXCEPT FOR 2 STOR OFFICE BUILDING) TO BE REMOVED AND 91 RESIDENTIAL UNITS, 33 PARKING SPACES, COMMON AREAS, AND MANAGEMENT OFFICE TO BE CONSTRUCTED.
2. ALL EXISTING WINDOWS AND WINDOW INFILLS TO BE REMOVED AND REPLACED WITH NEW ALUMINUM WINDOW ASSEMBLY, EXCEPT AS NOTED ON WINDOW REPLACEMENT SCHEDULE. SEE HISTORIC WINDOW SURVEY FOR REPLACEMENT SCHEDULE.
3. ALL EXISTING, ORIGINAL, INTERIOR PASSAGE DOORS ARE TO BE RETAINED AND NEEDED.
4. EXISTING WOOD FLOORING TO REMAIN IN PROPOSED COMMON AREAS.

#### KEY TO FLOOR PLAN NOTES

1. EXISTING STAIRS, HANDRAILS, INTERIOR FINISHES, AND EGRESS DOORS ARE TO BE RETAINED AND AS NEEDED. NEW RATED WALLS TO BE CONSTRUCTED AROUND OUTSIDE OF EXISTING SHAFT. THE STAIR IS TO REMAIN IN ACTIVE USE. SEE SHEET A6.01 FOR STAIR REHAB PLAN.
2. EXISTING STAIRS, HANDRAILS, AND INTERIOR FINISHES ARE TO BE RETAINED AND REPAIRED AS NEEDED. NEW RATED WALLS TO BE CONSTRUCTED AROUND OUTSIDE OF EXISTING SHAFT. EXISTING EGRESS DOORS ARE TO BE RETAINED, REPAIRED AS NEEDED, AND FIXED CLOSED. NEW OPENINGS TO BE CUT IN WEST SIDE OF EXISTING LANDING AND A RATED VESTIBULE TO BE CONSTRUCTED OUTSIDE OF THE STAIRWELL. THE STAIR IS TO REMAIN IN ACTIVE USE. SEE SHEET A6.01 FOR REHAB PLAN.
3. EXISTING STAIRS, HANDRAILS, AND INTERIOR FINISHES ARE TO BE RETAINED AND REPAIRED AS NEEDED. NEW RATED WALLS TO BE CONSTRUCTED AROUND OUTSIDE OF EXISTING SHAFT. EXISTING EGRESS DOORS ARE TO BE RETAINED, REPAIRED AS NEEDED, AND FIXED CLOSED. THE STAIR WILL ONLY BE ACCESSIBLE SEE SHEET A6.01 FOR REHAB PLAN.
4. COLUMN TO BE REMOVED TO ALLOW VEHICULAR ACCESS IN PROPOSED PARKING GARAGE. NEW BEAMS TO BE SISTERED TO EXISTING TO PROVIDE STRUCTURAL STABILITY.
5. NOT USED
6. EXISTING BASEMENT BASEMENT ACCESS STAIRS TO BE REMOVED AND OPENING IN FLOOR INFILLED. NEW BASEMENT ACCESS STAIRS TO BE CONSTRUCTED IN ADJACENT LOCATION.
7. EXISTING ELEVATOR AND SHAFT TO REMAIN, REPAIRED AS REQUIRED
8. NEW ELEVATOR SHAFT TO BE CONSTRUCTED AND NEW ELEVATOR INSTALLED.

#### Key Plan

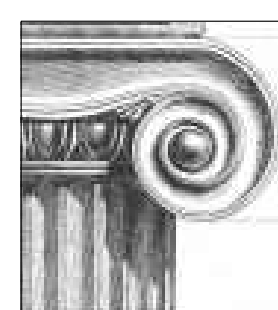
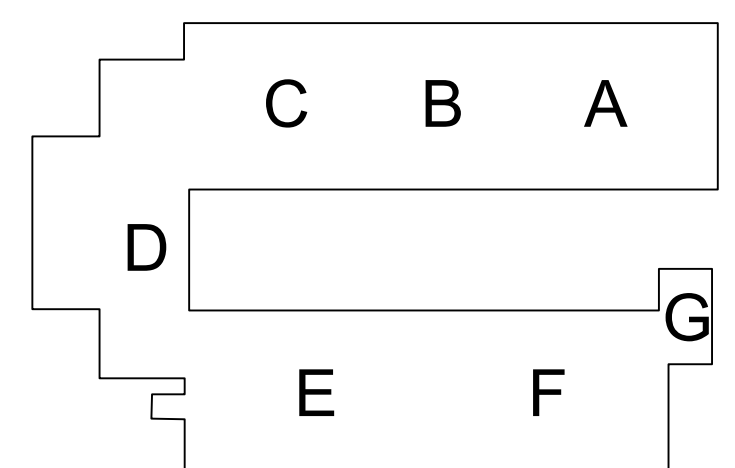

Hresko Associates, Inc.  
**Architect**  
**Landscape Architect**  
 110 Broad Street  
 Boston, MA 02110  
 617-350-7666  
 fax: 617-350-6260  
 eMail: hresko@ArchUSA.com

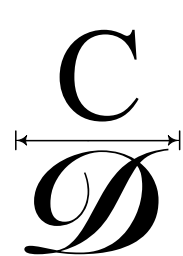

CONCISE DESIGN  
**Architects**  
 7 Kent Street #4  
 Brookline, MA 02445  
 617.285.0872  
 andrew@concisedes.com

# POCASSET MILL

75 Pocasset Street, Johnston, Rhode Island

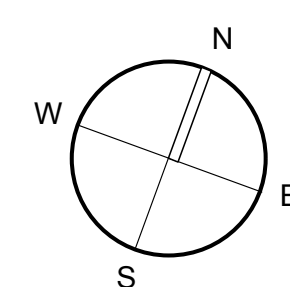

#### 2nd Floor Plan

Date: 6 January 2012  
 Scale: 1/16"= 1'-0"

#29-06

A  
 1.02



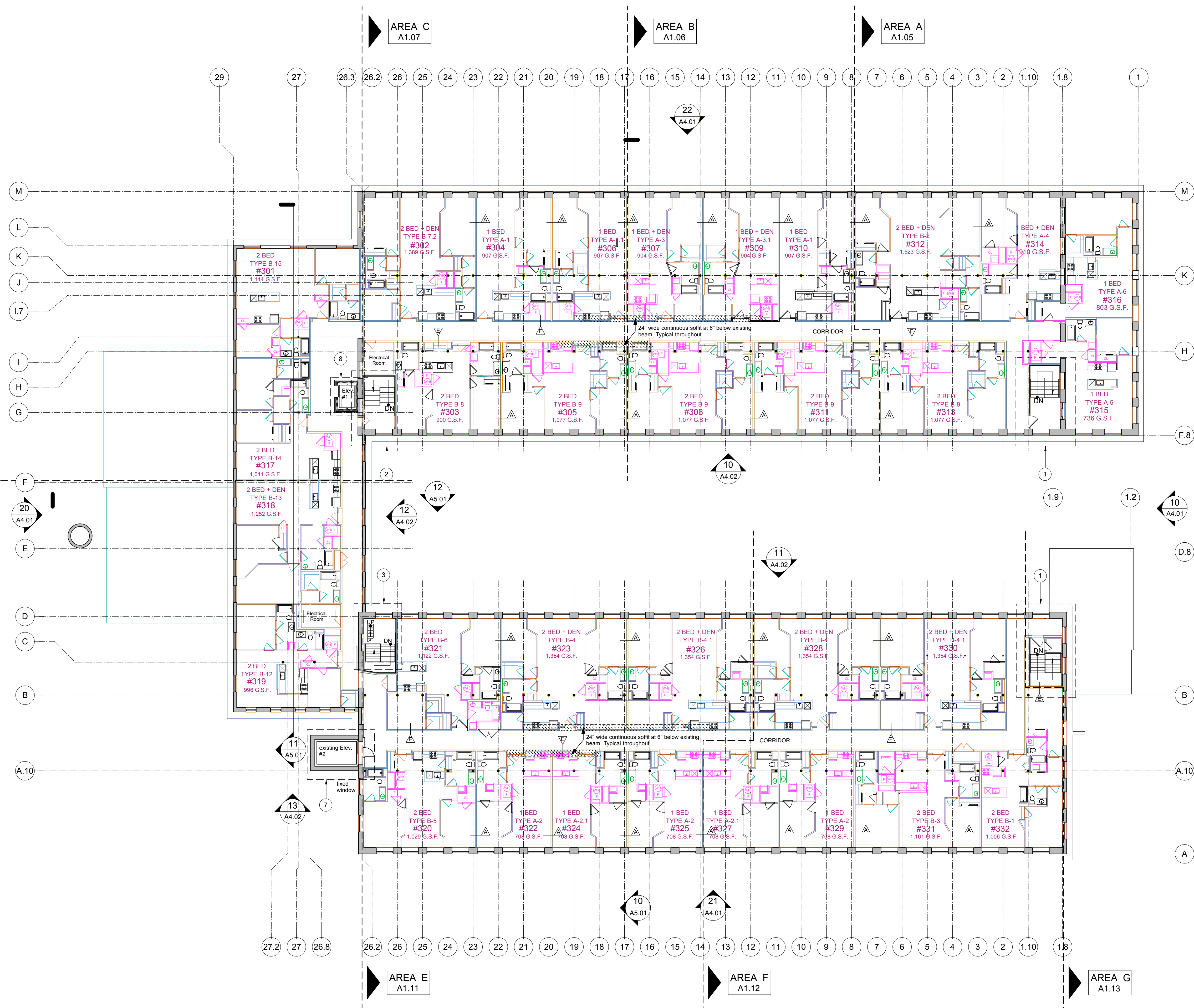

### GENERAL FLOOR PLAN NOTES

1. ALL EXISTING NON-STRUCTURAL WALLS, PLUMBING, ELECTRICAL AND MECHANICAL EQUIPMENT (EXCEPT FOR 2 STOR OFFICE BUILDING) TO BE REMOVED AND 91 RESIDENTIAL UNITS, 33 PARKING SPACES, COMMON AREAS, AND MANAGEMENT OFFICE TO BE CONSTRUCTED.
2. ALL EXISTING WINDOWS AND WINDOW INFILLS TO BE REMOVED AND REPLACED WITH NEW ALUMINUM WINDOW ASSEMBLY, EXCEPT AS NOTED ON WINDOW REPLACEMENT SCHEDULE. SEE HISTORIC WINDOW SURVEY FOR REPLACEMENT SCHEDULE.
3. ALL EXISTING, ORIGINAL, INTERIOR PASSAGE DOORS ARE TO BE RETAINED AND NEEDED.
4. EXISTING WOOD FLOORING TO REMAIN IN PROPOSED COMMON AREAS.

### KEY TO FLOOR PLAN NOTES

1. EXISTING STAIRS, HANDRAILS, INTERIOR FINISHES, AND EGRESS DOORS ARE TO BE RETAINED AND AS NEEDED. NEW RATED WALLS TO BE CONSTRUCTED AROUND OUTSIDE OF EXISTING SHAFT. THE STAIR IS TO REMAIN IN ACTIVE USE. SEE SHEET A6.01 FOR STAIR REHAB PLAN.
2. EXISTING STAIRS, HANDRAILS, AND INTERIOR FINISHES ARE TO BE RETAINED AND REPAIRED AS NEEDED. NEW RATED WALLS TO BE CONSTRUCTED AROUND OUTSIDE OF EXISTING SHAFT. EXISTING EGRESS DOORS ARE TO BE RETAINED, REPAIRED AS NEEDED, AND FIXED CLOSED. NEW OPENINGS TO BE CUT IN WEST SIDE OF EXISTING LANDING AND A RATED VESTIBULE TO BE CONSTRUCTED OUTSIDE OF THE STAIRWELL. THE STAIR IS TO REMAIN IN ACTIVE USE. SEE SHEET A6.01 FOR REHAB PLAN.
3. EXISTING STAIRS, HANDRAILS, AND INTERIOR FINISHES ARE TO BE RETAINED AND REPAIRED AS NEEDED. NEW RATED WALLS TO BE CONSTRUCTED AROUND OUTSIDE OF EXISTING SHAFT. EXISTING EGRESS DOORS ARE TO BE RETAINED, REPAIRED AS NEEDED, AND FIXED CLOSED. THE STAIR WILL ONLY BE ACCESSIBLE SEE SHEET A6.01 FOR REHAB PLAN.
4. COLUMN TO BE REMOVED TO ALLOW VEHICULAR ACCESS IN PROPOSED PARKING GARAGE. NEW BEAMS TO BE SISTERED TO EXISTING TO PROVIDE STRUCTURAL STABILITY.
5. NOT USED
6. EXISTING BASEMENT BASEMENT ACCESS STAIRS TO BE REMOVED AND OPENING IN FLOOR INFILLED. NEW BASEMENT ACCESS STAIRS TO BE CONSTRUCTED IN ADJACENT LOCATION.
7. EXISTING ELEVATOR AND SHAFT TO REMAIN, REPAIRED AS REQUIRED
8. NEW ELEVATOR SHAFT TO BE CONSTRUCTED AND NEW ELEVATOR INSTALLED.

### Key Plan

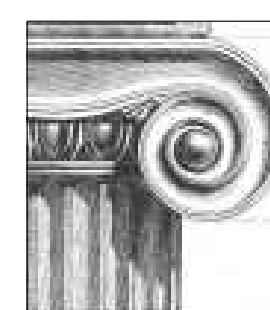
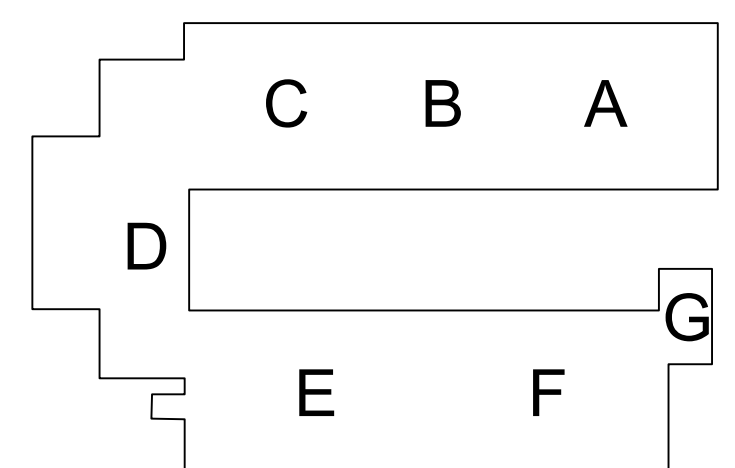

Hresko Associates, Inc.  
**Architect**  
**Landscape Architect**  
 110 Broad Street  
 Boston, MA 02110  
 617-350-7666  
 fax: 617-350-6260  
 eMail: hresko@ArchUSA.com

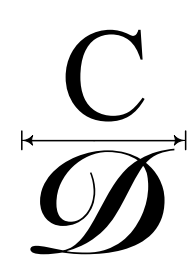

CONCISE DESIGN  
**Architects**  
 7 Kent Street #4  
 Brookline, MA 02445  
 617.285.0872  
 andrew@concisedes.com

# POCASSET MILL

75 Pocasset Street, Johnston, Rhode Island

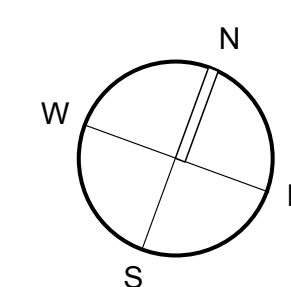

### 3rd Floor Plan

Date: 6 January 2012  
 Scale: 1/16"= 1'-0"

#29-06

A  
 1.03